

**Flexible.
Precise.
Unique.**

HC HOMAG

**Our Edge banding machines
EDGETEQ S-230**

YOUR SOLUTION



HOMAG Group

Success through partnership

To survive in a fiercely competitive market, a company has to have fast, flexible and efficient production.

The HOMAG Group, with its sales and service network in over 90 countries around the world, offers you and your employees a strong partnership no matter where you are.

The HOMAG Group of companies cover all areas of woodworking and wood-processing.

Panel sizing, sawing, edge technology, transportation technology and handling systems are just a few of our specialties. We also offer solutions for drilling, coating technology, surface technology, plants for doors and doorframes, timber house

construction, sanding technology, automation systems, packaging equipment and software. We provide a complete and innovative range of products and services that are always the perfect solution for any requirement.

You, our customers, benefit from high precision, performance and cutting-edge technology.



HOMAG

Perfect edges for demanding customers

We offer our customers innovative and powerful edgebanding machines. Efficiency and quality have the highest priority, and ensure long-term competitive advantages for you. With an annual production of over 2000 edgebanding machines, we are the edgebanding specialist in the HOMAG Group and the world leader in our market segment.

A high degree of standardization in combination with an advanced manufacturing process and more than 50 years of engineering experience ensure state of the art quality at a superb price-performance ratio. Our clear and structured product range is designed to meet the demands

of current and future market trends. All of our developments are focused toward practically-oriented and economic solutions that guarantee you the best possible production results.

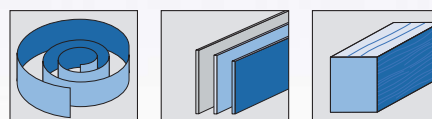

mm	Coil	Strips	Solid
a		min. 120	
b		8 - 50	
c		0,4 - 3	
d		55	

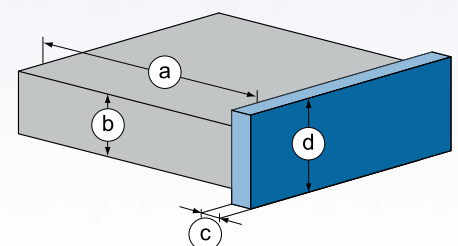

"Ideally prepared for your requirements"

"With us, you and your products come first.

A promise that you can count on!"

EDGETEQ S-230

Small machines to help you grow

The focus for the development of the EDGETEQ S -230 Series was to offer a complete processing solution in the entry level segment, with features which were previously only available on larger machines.

All machines are equipped with a precision gluing unit, a tiltable end trimming unit for straight and chamfer trimming and a top/bottom trimming unit. The feed speed of these models are 11 m/min.

For the complete processing options and a perfect finish, add a joint trimming unit, a contour trimming unit, a radius scraper, a glue joint scraper or a buffing unit.



The right solution for your requirements

The EDGETEQ S-230 Series machine leaves nothing lacking. Whether your needs are "batch size one" production, for demanding bespoke shop fitting applications, living & bed room furniture or functional office furniture, the EDGETEQ S-230 Series always offers the right solution for your requirements.

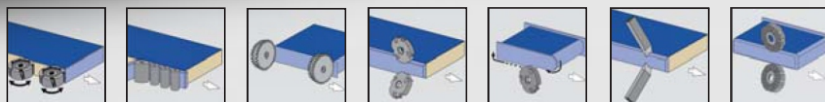

Optimal preparation for a perfect result



Contact heating shoe

As standard, all machines of the EDGETEQ S-230 Series are equipped with a contact heating shoe that optionally activated transfers contact heat into the board edge directly prior to the glue application to the workpiece edge, this notably optimising the gluing quality, especially with difficult edging materials or at very low ambient temperatures.

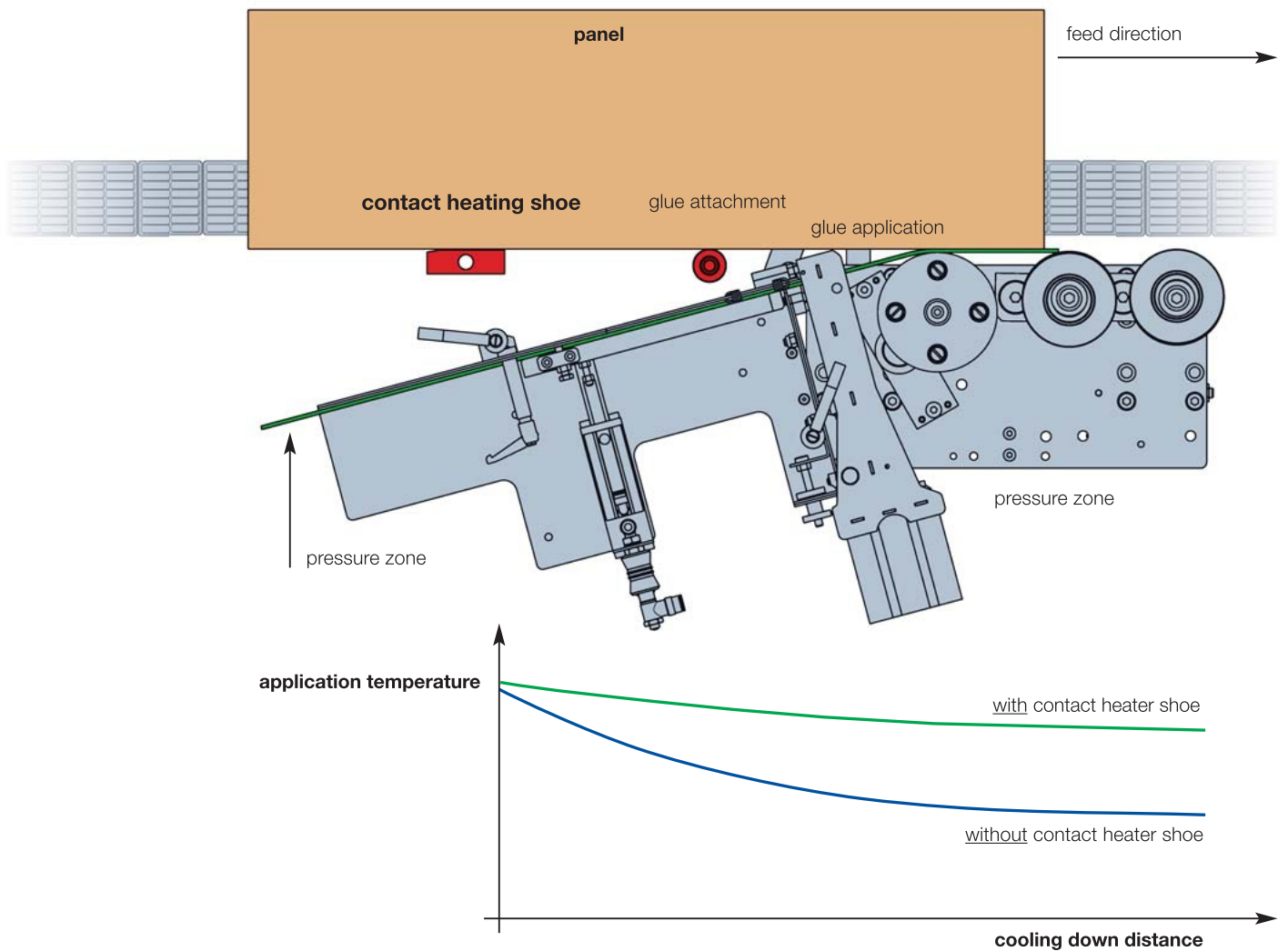

The controller

Quality and precision with the touch of a button

Through targeted and constant development of controller technology, simple operation and a high operating comfort are guaranteed. At HOMAG we focus on you as our customer and your finished product.

EDGETEQ S-230 / 220C / 220FC



easyControl EC 10+, offering every "plus" for the customer

- + High operating convenience through simple menu format and optimized linepoint adjustment.
- + Fast access to all unit functions through dedicated control buttons.
- + Quick change over to different edgbanding material through user-defined programs.
- + Easy to read large 4-line operating display
- + Clear text error diagnostics provide high operating convenience

EDGETEQ S-230 / 210 / 210F



Control System With Touch Screen

- + With a touch display in widescreen format for simple and comfortable operation and programming of the machine.
- + User friendly 5.5 " touch screen HMI for easy navigation and an intuitive operation of the machine
- + Intelligent display of readiness of production by light function
- + Clear text information about the status



Significant competitive advantages Pace setting performance and quality

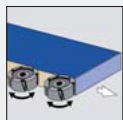

Joint trimming unit

Perfect cut and high operating life due to diamond tipped tools for an optimum edge joint quality.

Counter pressure device

Counter pressure device magazine for sensitive edges.

Gluing unit and magazine

Coil and automatic strip magazine for a reliable edge material supply. Optimal glue joints, by controlling the exact amount of glue.

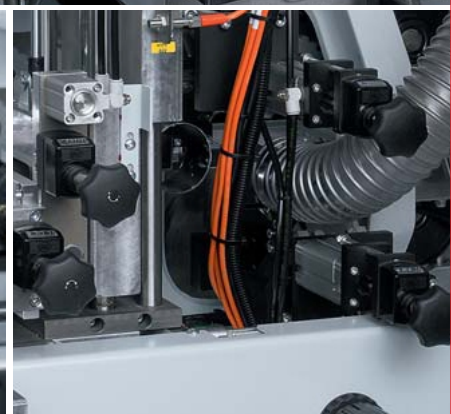

Trimming unit

Trimming unit with DFC tool technology for optimum dust extraction.

Trimming unit with pneumatic 3-point adjustment (optional)

For even more effective production and much shorter changeover time.

Corner rounding unit

Optimum corner rounding without adjustment or set-up, resulting from the coupled diamond tool and tracer roller. Workpiece thickness up to 40 mm.

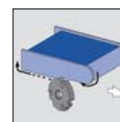
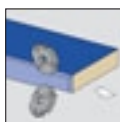
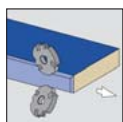

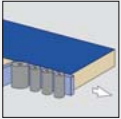

Pressure zone

Heavy pressure zone up to 3 mm edge thickness and 50 mm workpiece height for an optimal glue joint.

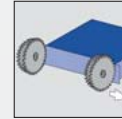

End-trim unit

Precise end-cut through a strong end-trimming unit, equipped with THK guides. Chamfer/straight adjustment by easily tilting the unit.

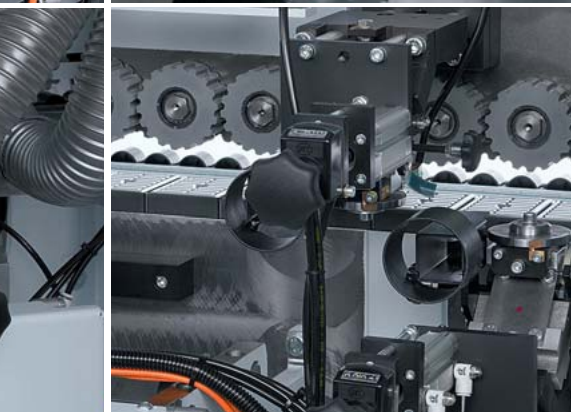
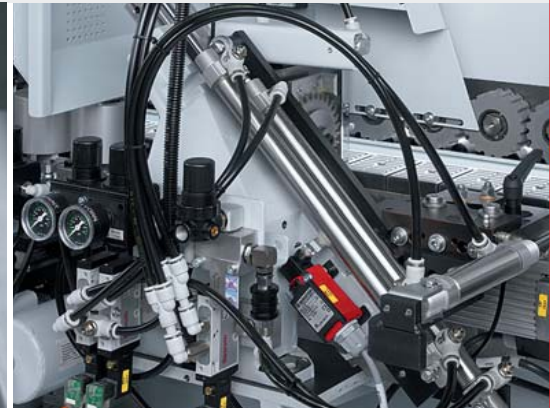

Profile scraping unit

Unit to smooth radii or chamfers, equipped with quick change heads for fast profile

**Glue joint scraping unit (optional)
- In lieu of profile scraping or buffing unit**

For the perfect finish.

Buffing unit

Buffing unit to polish edges and maintain their natural colour.

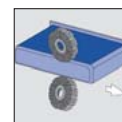
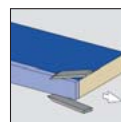
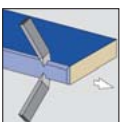

HOMAG EDGETEQ S-230 / Technical Data

	210	210F
Machine length (mm)	3650	
Working height (mm)	950	
	1300 x 2180	
	Working dimensions	
Workpiece thickness (mm)	8 - 50	
Edge material thickness (mm)	0,4 - 3	
	Miscellaneous	
Feed speed (m/min)	11	
Weight (kg)	1180	
Connected value (kw)	5	9.5
Extraction diameter (mm)	3x80/1x100	1x120/3x80/1x100
Electrics	400 V - 3 Ph - 50 Hz	
Pneumatics (bar)	6	

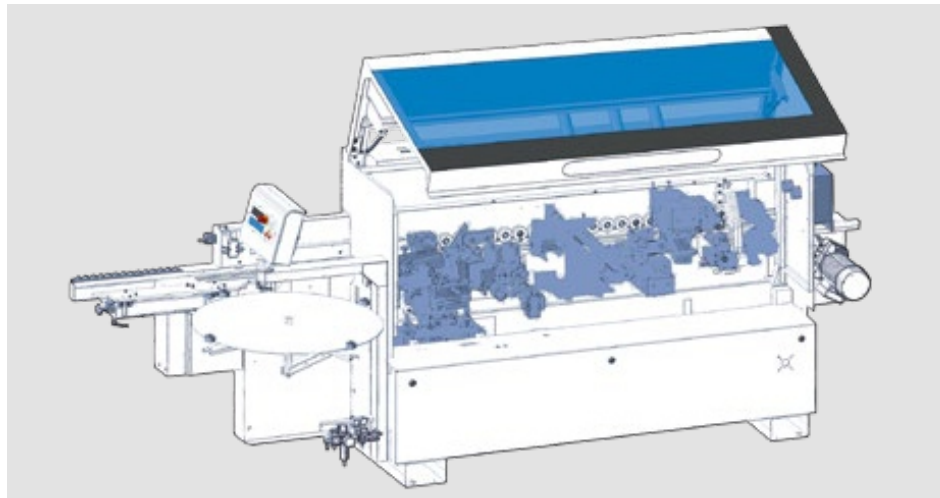
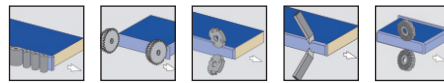

Model 210

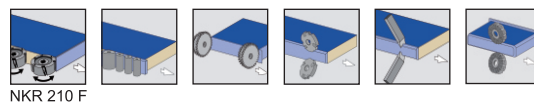

NKR 210 F

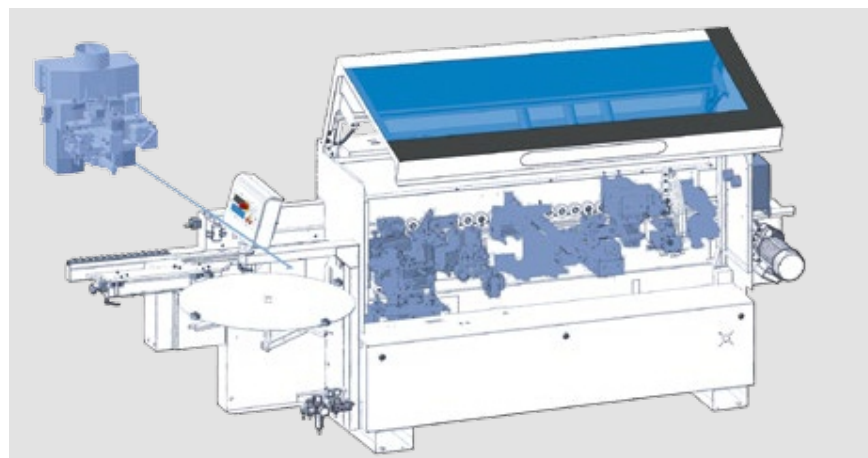

Model 210F

	220 C	220 FC	220 FC P
Machine length (mm)		4150	
Working height (mm)		950	
Machine dimensions WxH (mm)		1300 x 2180	
		Working dimensions	
Workpiece thickness (mm)		8 - 50	
Edge material thickness (mm)		0.4 - 3	
		Miscellaneous	
Feed speed (m/min)		11	
Weight (kg)	1270		1320
Connected value (kw)	5.5		10
Extraction diameter (mm)	3x80/1x100		1x120/3x80/1x100
Electrics		400 V - 3 Ph - 50 Hz	
Pneumatics (bar)		6	

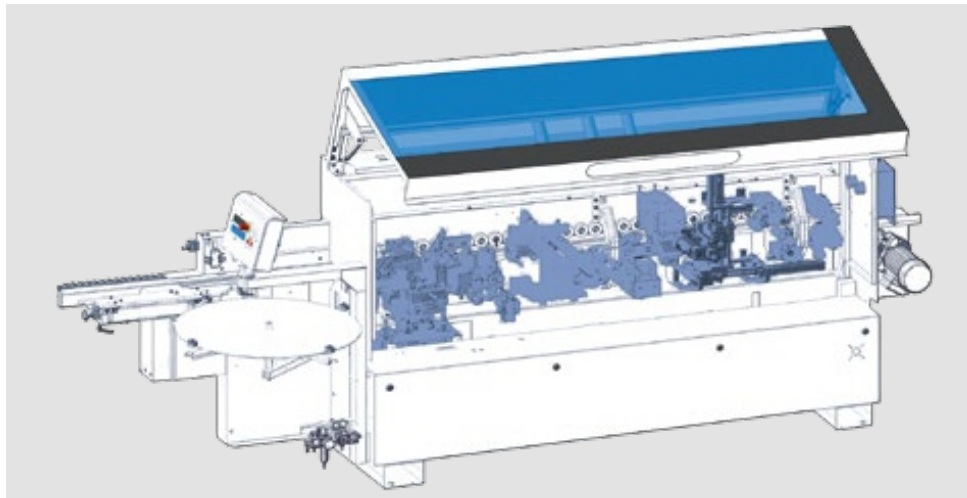
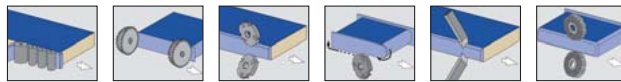

Model 220 C

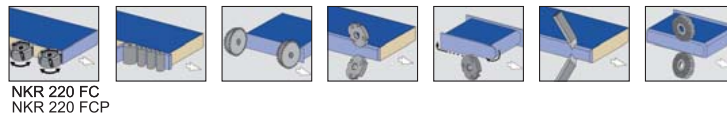

NKR 220 FC
NKR 220 FCP

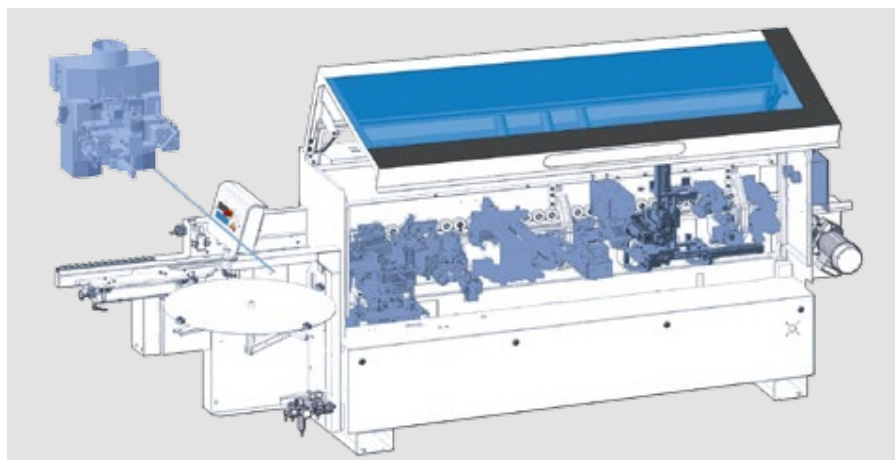

**Model 220 FC
Model 220 FCP**

HOMAG Group AG

www.homag.com



YOUR SOLUTION

HC HOMAG

HOMAG India Pvt. Ltd.

Head Office & Knowledge Centre
No.88 Industrial Suburb, II Stage,
Tumkur Road, Bangalore - 560022,
Karnataka State, India.
Tel.: +91 80 23575421 / 22 / 23 / 24
email:info@homag.com